

**BOLT-ON-HUBS**

Fenner Taper Lock Bolt-on Hubs are designed for use with the universally accepted Taper Lock bush.

They provide a convenient means of securing fan rotors, impellers, agitators and other devices which must be fastened firmly to shafts.

Product Code	Size	Use Bush Size	D <sub>1</sub>	D <sub>2</sub>	D <sub>3</sub> *	D <sub>4</sub>	D <sub>5</sub>
017C0010	<b>BF12</b>	1210	120	100	80	74	80
017G0010	<b>BF16</b>	1610	130	110	90	84	90
017K0010	<b>BF20</b>	2012	145	125	100	99	100
017M0010	<b>BF25</b>	2517	185	155	130	120	119
017P0010	<b>BF30</b>	3020	220	190	165	146	147

\*Bore tolerance of D<sub>3</sub> +0mm/-0.05mm is recommended

Product Code	Size	Use Bush Size	L <sub>1</sub>	L <sub>2</sub>	L <sub>3</sub>	L <sub>4</sub>	B
017C0010	<b>BF12</b>	1210	25	10	6.5	2.5	M6
017G0010	<b>BF16</b>	1610	25	10	6.5	2.5	M6
017K0010	<b>BF20</b>	2012	32	13	8.5	2.5	M8
017M0010	<b>BF25</b>	2517	44	20	11.5	2.5	M10
017P0010	<b>BF30</b>	3020	50	20	11.5	2.5	M16

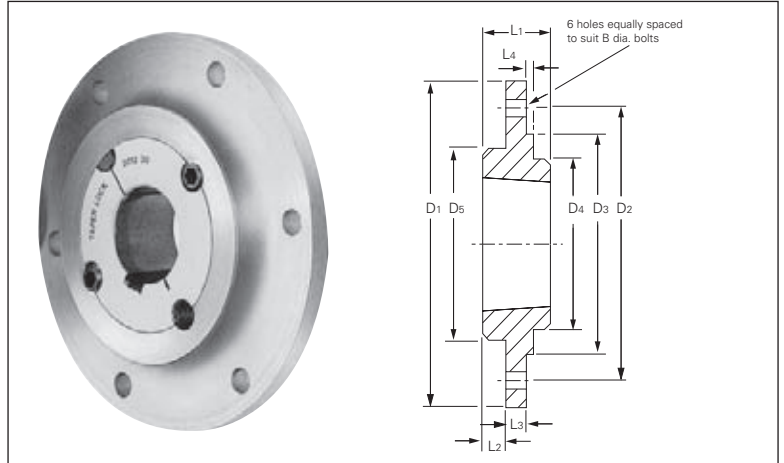

**ADAPTORS**

Adaptors for Fenner Taper Lock bushes are available for use in parallel bored components, either keyed (KM) or plain (PM) thereby eliminating the need to drill, tap and taper-bore.

Product Code	Hub ref.	L <sub>1</sub>	D <sub>2</sub>	Key Section	Hub dia. D		
					Cast Iron BS1452 GG - 20 - 25	Steel BS970Pt1 070M20	
030A0200	<b>1008PM</b>	22	45	-	71	62	56
030A0210	<b>1008KM</b>			5 x 5	75	67	60
030C0200	<b>1210PM</b>	25	60	-	97	85	76
030C0210	<b>1210KM</b>			6 x 6	103	93	85
030G0200	<b>1610PM</b>	25	70	-	106	95	86
030G0210	<b>1610KM</b>			10 x 8	113	102	92
030M0200	<b>2517PM</b>	45	105	-	145	133	121
030M0210	<b>2517KM</b>			16 x 10	151	140	127
030Q0200	<b>3030PM</b>	76	130	-	181	165	156
030Q0210	<b>3030KM</b>			20 x 12	191	175	159
030R0200	<b>3535PM</b>	89	160	-	225	203	191
030R0210	<b>3535KM</b>			22 x 12	235	213	200
030S0200	<b>4040PM</b>	102	185	-	275	248	229
030S0210	<b>4040KM</b>			24 x 12	285	257	238

\*Bore tolerance of D<sub>3</sub> +0.025/+0.075mm recommended  
All dimensions in millimetres.

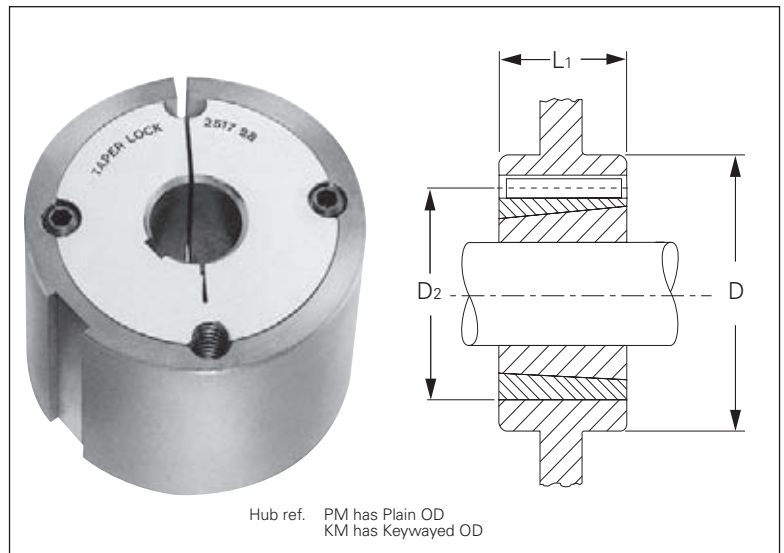

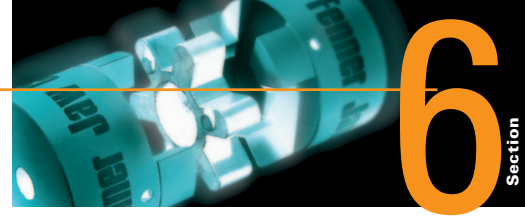

### WELD-ON-HUBS

Fenner Taper Lock Weld-on Hubs are made of steel, grade 070M20, drilled, tapped and taper bored to receive standard Taper Lock bushes.

The shouldered outer diameter provides a convenient means of welding hubs into fan rotors, steel pulleys, plate sprockets, impellers, agitators and many other devices which must be firmly fastened to the shaft.

Product Code	Size	Use Bush Size	D <sub>1</sub>	D <sub>2</sub> *	D <sub>3</sub>	L <sub>1</sub>	L <sub>2</sub>	L <sub>3</sub>
025C0010	WH12	1210	70	65	64.5	25	9	10
025G0010	WH16	1610	80	75	74.5	25	9	10
025K0010	WH20	2012	95	90	89.5	32	12	12
025M0010	WH25	2517	115	110	109.5	44	19	15
025P0010	WH30	3020	145	140	139.5	50	20	15
025J0010	WH35	3525	190	180	179.5	65	25	25
025X0010	WH40	4030	200	190	189.5	76	32	30
025Y0010	WH45	4535	210	200	199.5	89	40	30
025Z0010	WH50	5040	230	220	219.5	102	40	35

\*Bore tolerance of D<sub>2</sub> +0mm/-0.05mm is recommended

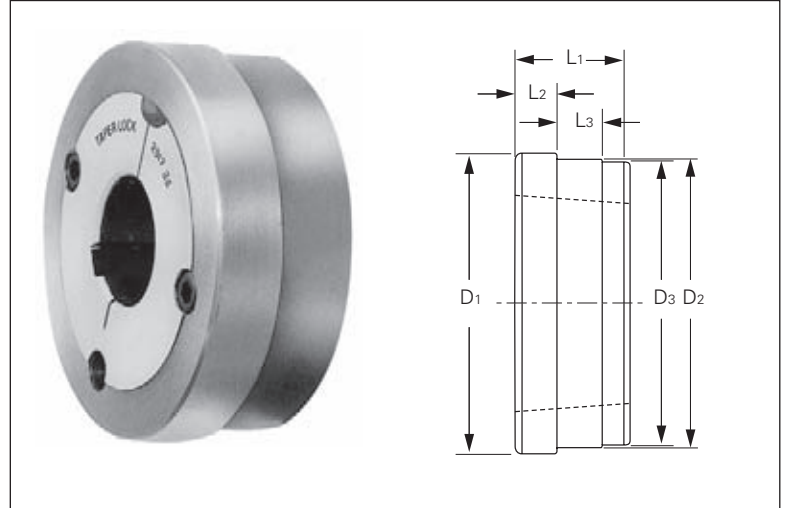

### WELDING INSTRUCTIONS

Fenner Taper Lock Weld-on Hubs are made of steel, are machined to accept Taper Lock bushes for shaft fixing, and have a precision machined shoulder against which flanges or webs can be located.

It is recommended that a continuous 45° mitre weld be used, working on the larger hub diameter section only. To ensure accuracy in the welded assembly it is essential to apply only sufficient weld to achieve sufficient strength.

Excess weld should not be necessary for normal use and, due to greater heat input, gives a higher risk of distortion.

The table below shows recommended continuous fillet weld requirements for each hub size.

Hub No	Leg Length mm
WH12	4
WH16	4
WH20	5
WH25	5
WH30	6
WH35	6
WH40	8
WH45	8
WH50	10

For electric arc welding, low hydrogen electrodes are recommended

